

67

L67

Le Balcon de L' Yse

T2 - 4 lits / lot N° 67

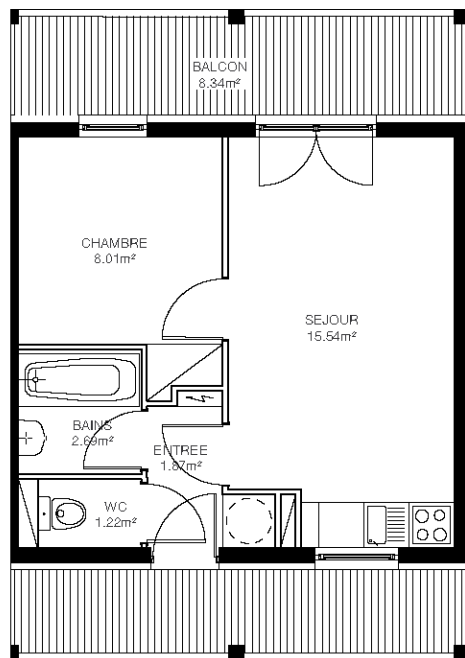

REZ DE CHAUSSEE

SEJOUR	15,54 m2
CHAMBRE 1	8,01 m2
SALLE DE BAINS	2,69 m2
WC	1,22 m2
ENTREE	1,87 m2

BALCON TERRASSE 8,34 m2

SURFACE HABITABLE 29,33 m2

